



INTRODUCING

BIGGEST GREEN PRODUCTION UNIT

LOCATION

ONDA
CASTELLON - SPAIN



PLANT AREA



The total area equipped for same is 2.5 million sq. feet & built up area is 2 million sq. feet. Which is largest production unit at single location in Asia with most advanced technology



SIZES & THICKNESS

The new plant with the latest line ups & technology will be producing a versatile range of surfaces of porcelain, stoneware, full body & through body veining slabs for the most sought contemporary design & ambience need of the modern day customer. Few more sizes to add on 1200x1200; 1200x2600; 1200x3200; 800x2400 etc.

15mm, 20mm
800X3200mm

6mm, 12mm 15mm, 20mm
1600X3200mm

6mm, 15mm, 20mm
800X3000mm

6mm, 9mm
1200X2800mm

9mm, 12mm
1200X2400mm

9mm, 12mm
1200X1800mm

9mm, 12mm
1600X1600mm

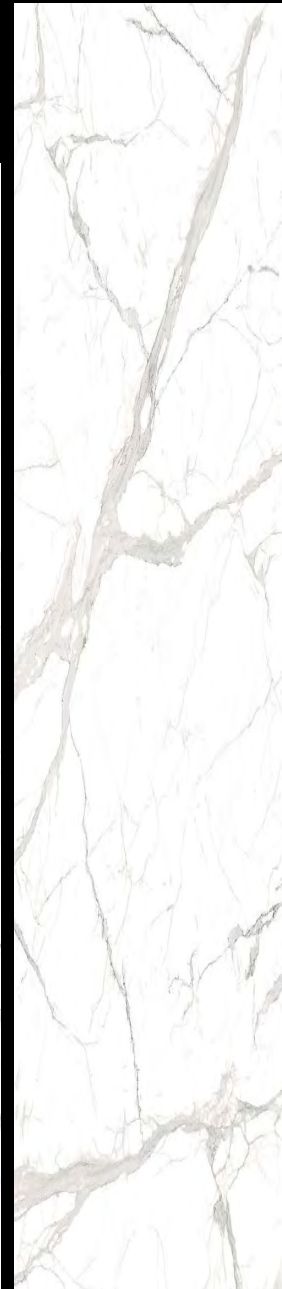
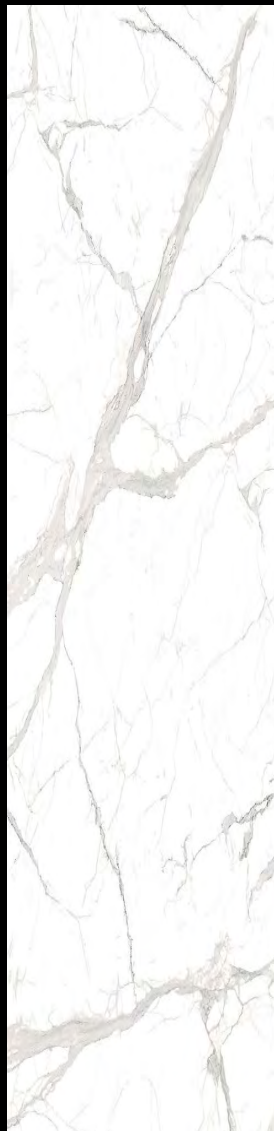
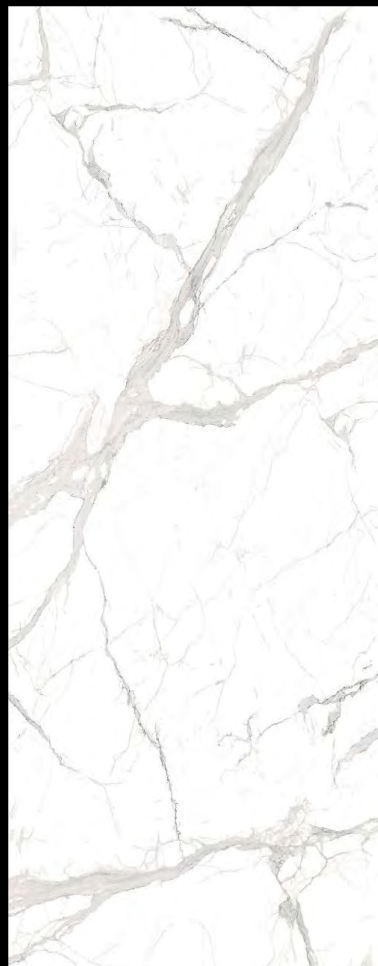
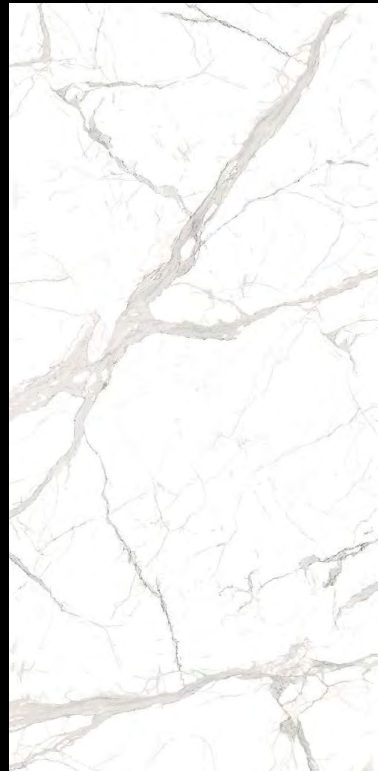
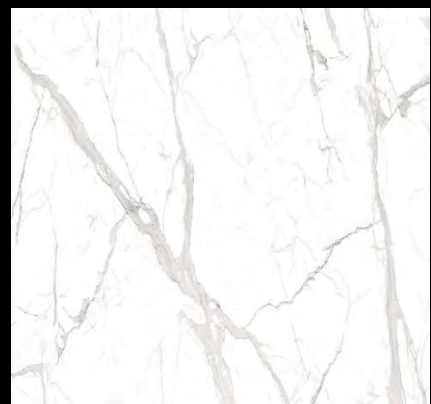

BALL MILL

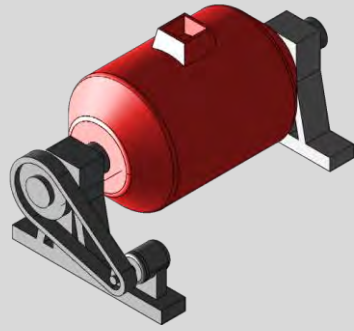

HAOFENG



9 Ball mills each of 60 ton capacity, equipped with lining from **SACMI ITALY** Installed for 1st Time in Asia from **HAOFENG**, which is well known for its energy efficient Ball mills. Output of which gives you accurate & proper grinding material. Out of 9 ball mills few will be assigned for few specific colors like black ,white & multicolor.



SPRAY DRYER



SACMI



ATI 110 – 1 nos.

ATI 065 – 2 nos.

SACMI Spray Dryers which is environment friendly, which are accurate in producing the best quality powder for best quality product. Out of 3,1 Spray drier is exclusive for white body product.



CONTINUOUS SLAB PRODUCTION LINES



- **C + PCR 2120 – W 1200mm**
- **C + PCR 2000 – W 1600mm**

This is a Smart Advanced Technology.



DRYER 



2 Multi-Layer Dryer by SACMI



GLAZED LINE



2 Glazing Line for Glaze Application of AIRPOWER – ITALY, which is equipped with FLAT BELT Technology Conveyer for more accurate & Flat Glaze Application



DIGITAL PRINTER



a coesia company



SYSTEM CREADIGIT INFINITY

First time in Asia with the latest digital printers of infinity models to produce full digital printing products by 4 + 12 color bars in both the lines.



KILN



SACMI



3 Production line (Kiln) from SACMI which is Most Advanced in Market, All Kilns are Energy Efficient and Environment friendly with lowest carbon emission. Kiln are accurate for its air system & flame system for fabricating better products.



LAPPING LINE WITH SUPER SHINE TECHNOLOGY

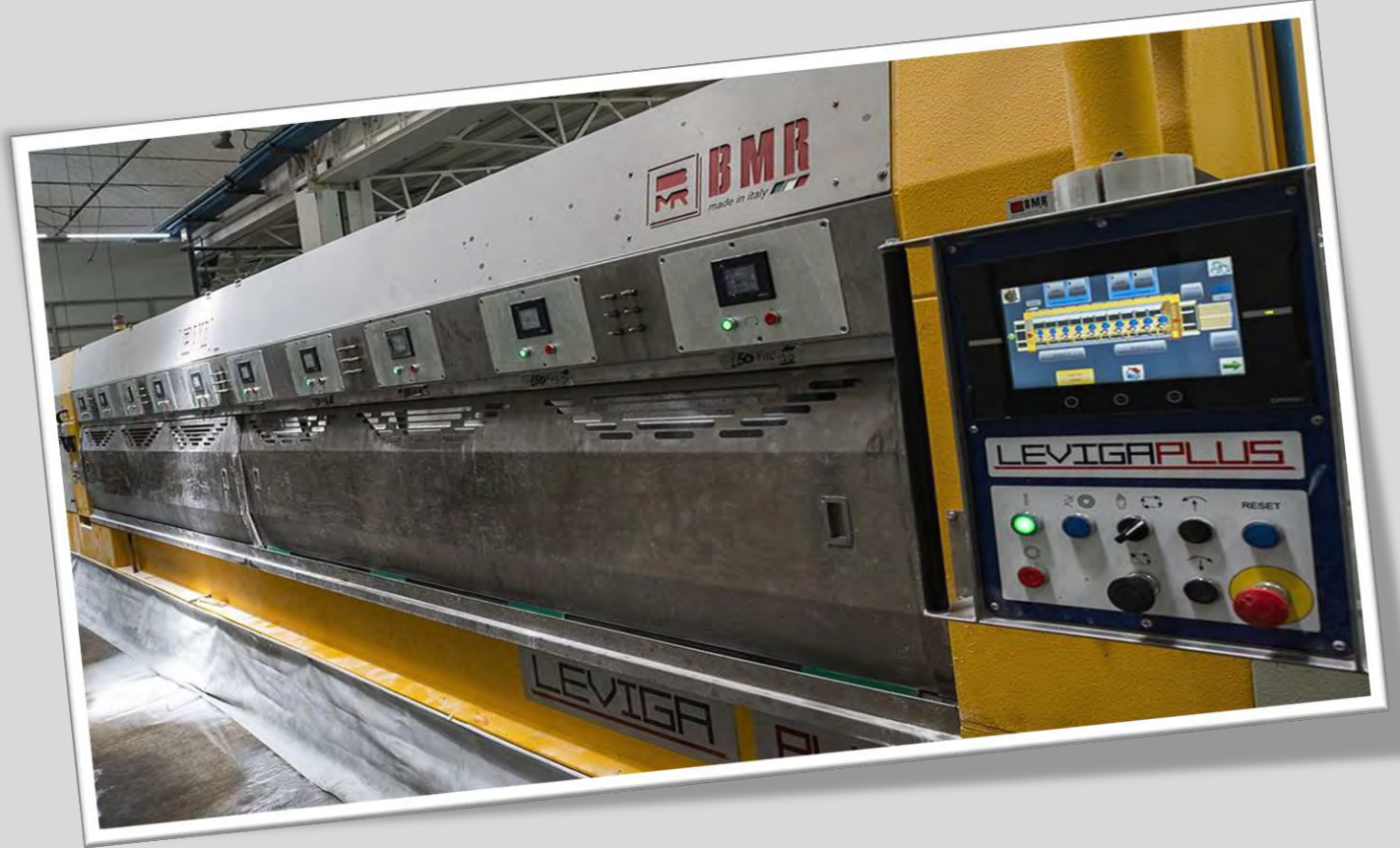
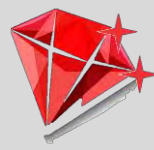

**2 State of The Art Lapping Line, Supplied
By BMR – Italy, Pioneer of Polishing
Equipment**



ONLINE Q.C.



Television-Auto the largest generation of automatic sorting system manufactured by Italtvision Italy. Machine classifies the quality through micro defects on the surface ,size, diagonal, planarity of the finished product.



TECHONOLOGICAL TOWER



TECHNOLOGY

TECHNOLOGY



LB technology with easy color boost , technological tower and automatic powder handling system and new technology feeder for producing alike to natural marble.



FABSHOP PRODUCTION

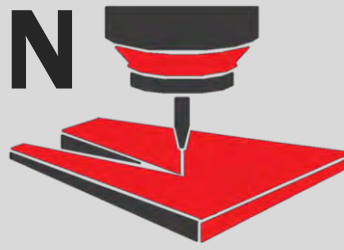

INTERMAC



FABSHOP PRODUCTION FACILITY FOR-

- **COUNTER TOP**
- **KITCHEN TOP**
- **TABLE TOP**

**By using CNC and Bridge saw machines
from Italy.**



NET GLUING

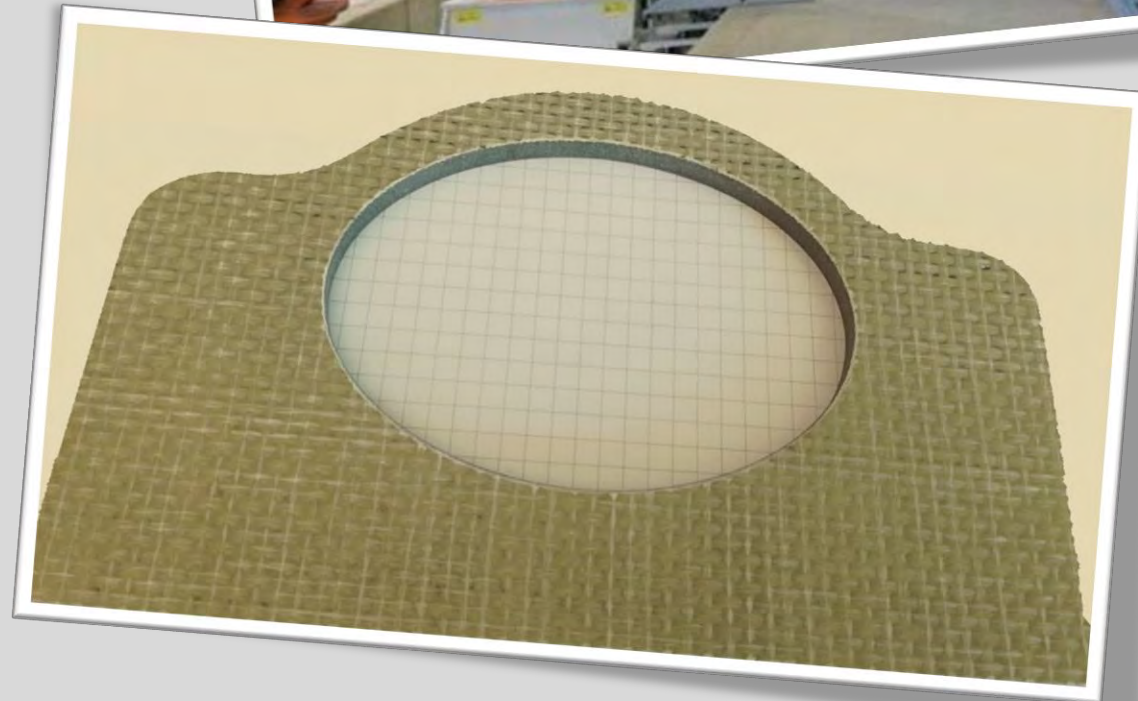

Netting line from SIMEC Italy with two robots and a precise dosing system to the reinforcement of fibre net at the bottom of slabs.

LAB FOR R&D



inter  ser

 **SASSUOLOLAB**_{S.R.L.}
STRUMENTI PER LE INDUSTRIE CERAMICHE E LABORATORI



A ceramic R & D centre with a fully equipped laboratory in collaboration with Sassuolo lab, Italy.



WATER RECYCLING



Zero waste water unit for water Recycling Plant from ITALY.





THANK YOU..!

www.cera-world.com

